

## Land Sales in Placer County

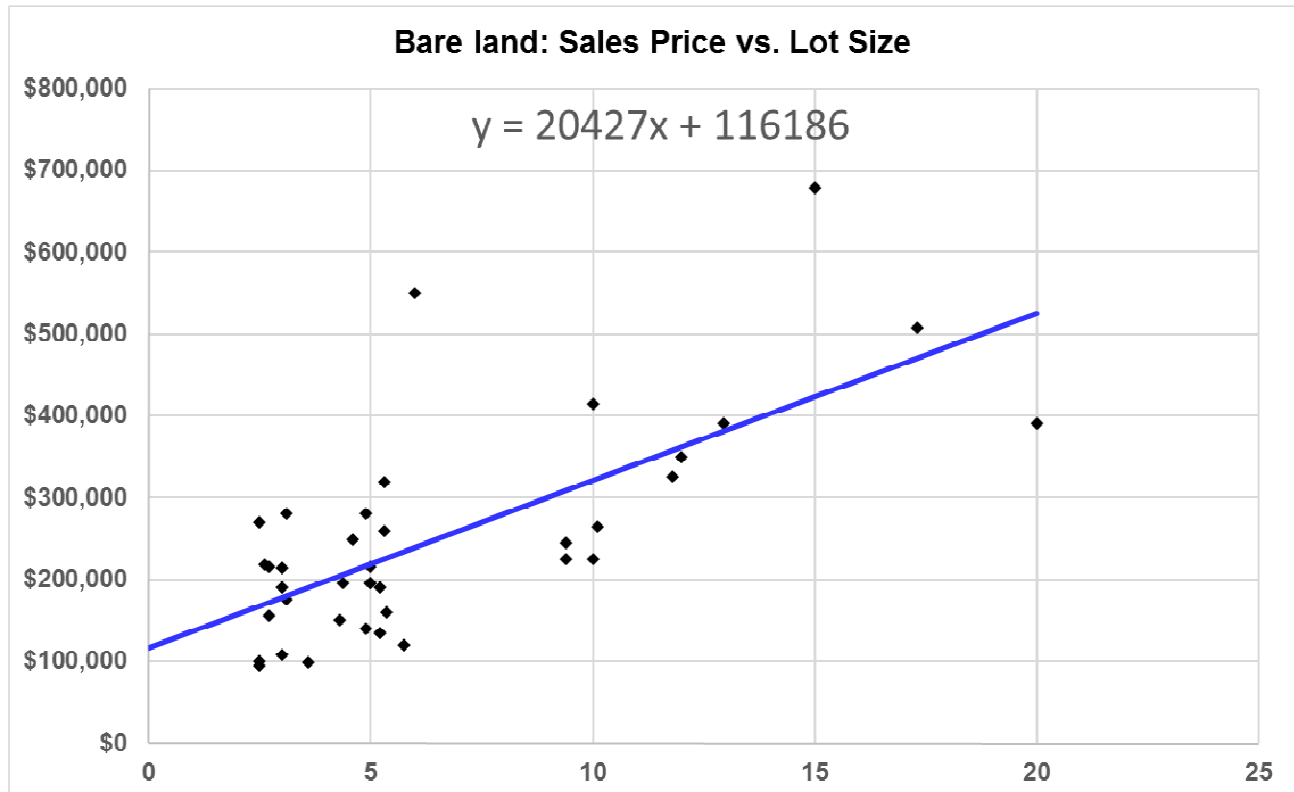

This is a graph of residential and agricultural bare land sales in the past year through most of the midsection of Placer County, from the Colfax area through lower Loomis. The data is placed in the graph above with number of acres along the bottom and sales price along the left side. This graph does not account for slope, views, wells, septics, or outbuildings, it mixes all sold properties between 5 and 20 acres. But if data is selected along certain parameters, then those features can be examined more closely.

The Excel program draws a linear trend line and provides the formula above. That formula at the top means that the base price for land in this area is \$116,186, plus \$20,427 per acre of land. This is more accurate than a simple price per acre on the one hand, or on the other hand a single price for each lot, regardless of size. Using these numbers, an average 5-acre parcel sold for \$218,000, 10 acres sold for \$320,000 and 20 acres sold for \$525,000. 02/18/2016



### Don Machholz | Don's Appraisals

Certified Residential Appraiser

List price appraisals to help set/reset price of house for about \$275

Other types of appraisals also available

Office: 530.320.8204

Email: [donthepappraiser@aol.com](mailto:donthepappraiser@aol.com)

Website: [donsappraisals.com](http://donsappraisals.com)

Go to my web site for past issues of these handouts